



# Contractor Advisory Committee (CAC) Meeting

**Medicare Part B  
Provider Outreach and Education (POE)**

October 2015

**noridian**

*Healthcare Solutions*

## Part B Education News



# REMINDER

## ACT

- Ask the Contractor Teleconference (ACT) – Part B
- One hour call with all Noridian departments
- May submit prior question (up to 5 days before ACT)
- Toll free and no registration
- JF <https://www.noridianmedicare.com/partb/train/act/index.html>

Date	Central Time	Topic	Toll Free Number
10/15/15	3:00 pm	General – Fourth Quarter	<b>800 553 5260</b>

# Enrollment Education

- Please share with staff about Enrollment/ PECOS webinars

Date	Description
10/29/15	Using PECOS to Report a Change of Information in Part B Enrollment

# ICD-10-CM Physician Orders

- Physician orders with ICD-9 diagnoses for lab, DME, radiology **before** October 1, but performed after October 1 date of service
  - No need to change ICD-9 diagnoses
- General Equivalence Mapping (GEM) option
  - 2016 ICD-10-CM and GEMs web page
  - Translates ICD-9-CM into ICD-10-CM diagnosis
- Physician orders written **after** transition to ICD-10 must use ICD-10-CM diagnosis(es)

# ICD-10-CM National Policies

- CMS provided NCD table for updating to ICD-10 diagnosis codes
  - <https://www.cms.gov/Medicare/Coverage/CoverageGenInfo/ICD10.html>
- Documents included Change Requests (CRs) and Medicare Learning Network (MLN) articles

# Paper Claim Submission

- For claims received by Noridian as of 10/1/2015, the ICD-9/ICD-10 indicator will be required
  - If this indicator is left blank, the claim will be denied
  - Resubmit the claim with an indicator of 9 for ICD-9 codes or a 0 (zero) for ICD-10 codes
  - Enter the ICD indicator as a single digit between the vertical, dotted lines

21. DIAGNOSIS OR NATURE OF ILLNESS OR INJURY Relate A-L to service line below (24E)				ICD Ind.
A. _____	B. _____	C. _____	D. _____	←
E. _____	F. _____	G. _____	H. _____	
I. _____	J. _____	K. _____	L. _____	

# Who is the ICD-10 CMS Ombudsman?

- Dr. William Rogers  
[lcd10\\_ombudsman@cms.hhs.gov](mailto:lcd10_ombudsman@cms.hhs.gov)
- His role as ombudsman is a one-stop shop for provider questions and concerns
- To be your CMS internal advocate



# Self-Paced Training Tutorials

## Part B Trainings Currently Available

Advance Beneficiary Notice (ABN)	CMS-1500 Claim
Accessing CMS Web Training	Endeavor Portal
ICD-10 Overview	

**Access Training Here for JFB:**

<https://med.noridianmedicare.com/web/jfb/education/event-materials>

# Surveys

- MAC Satisfaction Indicator (MSI) Collection
  - Thank you to all who completed!
  - Noridian had the most surveys collected of all contractors
- Web Satisfaction Survey
  - Continue to provide constructive/complimentary feedback to Noridian website growth and improvement

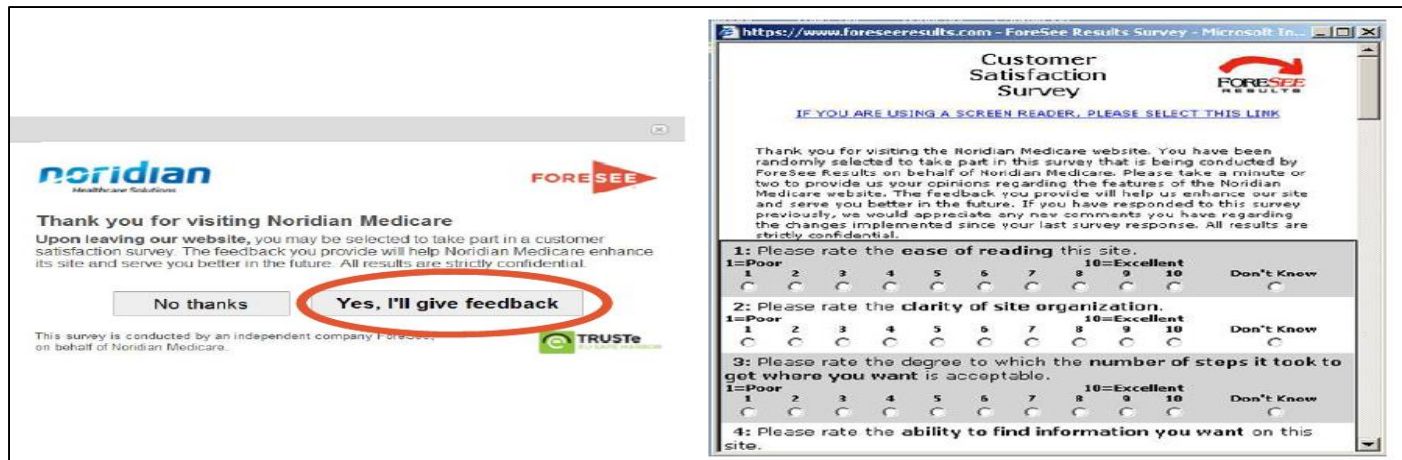

# Webinars - Part B

Date	Time (CT/PT)	Webinar Title
10/20/15	1:00 PM/11:00 AM	Polysomnography/Sleep Studies
10/20/15	1:00 PM/11:00 AM	Outpatient Therapy
10/22/15	1:00 PM/11:00 AM	ICD-10 Overview
10/28/15	1:00 PM/11:00 AM	CERT Basics
10/29/15	1:00 PM/11:00 AM	Compliance
<p style="text-align: center;">Register Now!</p> <p><b>JE</b> <a href="https://med.noridianmedicare.com/web/jeb/education/training-events">https://med.noridianmedicare.com/web/jeb/education/training-events</a></p> <p><b>JF</b> <a href="https://med.noridianmedicare.com/web/jfb/education/training-events">https://med.noridianmedicare.com/web/jfb/education/training-events</a></p>		

**noridian**

*Healthcare Solutions*



**Thank you!**